

# *Union Colony Civic Center*

## *Hensel Phelps Theatre Technical Specifications & Information Packet*

UNION  
COLONY  
CIVIC  
CENT

[www.UCStars.com](http://www.UCStars.com)

*Updated Sept. 2011*

# General Information

Mailing Address: 701 10<sup>th</sup> Ave  
Greeley, CO 80631  
(Loading dock access is from 11<sup>th</sup> Ave and 7<sup>th</sup> street)

Staff:

Mark Breimhorst, <i>UCCC Director</i>	970-350-9768
Jason Evenson, <i>Technical Services Coordinator</i>	970-350-9482
Jill Droegemueller, <i>Scheduling Coordinator</i>	970-350-9449
Mari Hein, <i>Ticket Office Coordinator</i>	970-350-9470
Andy Segal, <i>Marketing Coordinator</i>	970-350-9455

Hotels: (Official Season Sponsor 2010-2011)

Days Inn — 5630 10 <sup>th</sup> Street (4 miles)	970-392-1530
Fairfield Inn — 2401 W. 29 <sup>th</sup> Street (3.7 miles)	970-339-5030

Taxi Service:

Super Shuttle - Greeley	970-686-5555
-------------------------	--------------

Limo Service:

Northern Colorado Limousine	970-351-0516
First Choice Limousines	970-346-0919

Music Stores:

Campus Music Store — 907 16 <sup>th</sup> Street	970-353-0572
Greeley Guitar Center — 915 16 <sup>th</sup> Street	970-353-0806
Kimbrel Music Inc. — 823 10 <sup>th</sup> Street	970-352-1436

Restaurants:

See next page

Emergency Numbers:

Fire, Police, Ambulance	911
Hospital – North Colorado Medical Center	352-4121
Poison Control	1-800-332-3073
Doctor – Greeley Medical Clinic — 1900 16 <sup>th</sup> St.	353-1551
Laundry — 1624 8 <sup>th</sup> Ave	356-3053
Cleaners — 1214 9 <sup>th</sup> Ave	352-3210

Time Zone:

Mountain

# Restaurants in the Downtown Greeley Core

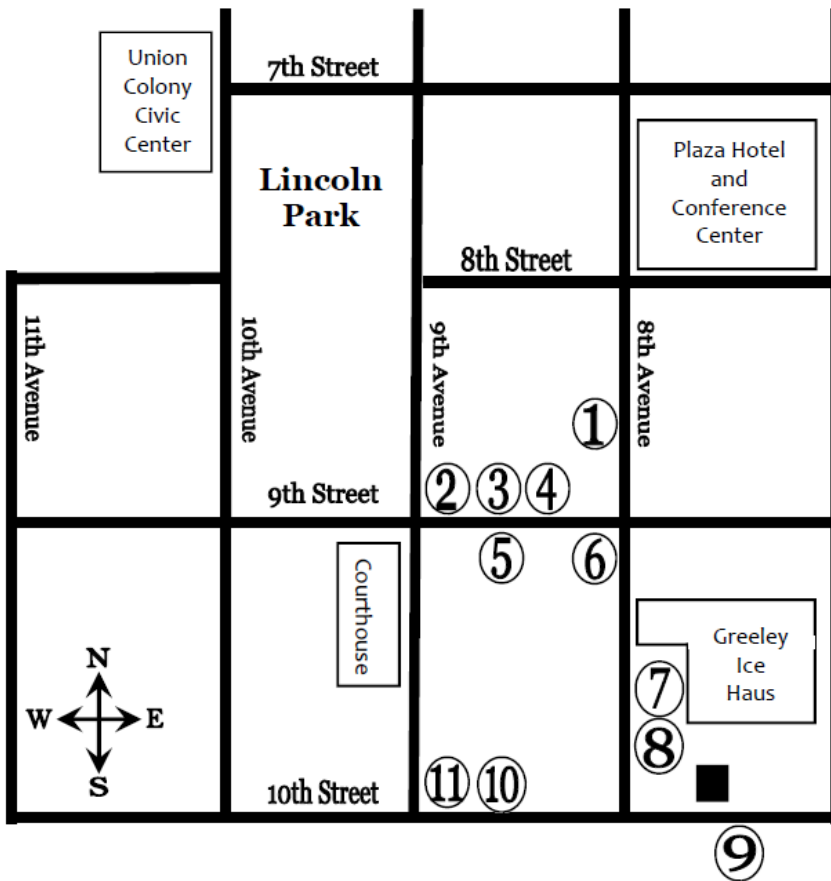

- 1 **The Kress Cinema & Lounge**  
817 8th Ave., 515-5716
- 2 **Rio Grande Mexican Restaurant**  
825 9th St., 304-9292
- 3 **The Armadillo**, 819 9th St., 304-9024
- 4 **Dutch's**, 813 9th St., 352-9110
- 5 **The Penalty Box**, 822 9th St., 301-4212  
**The Jager**, 822 9th St., Lower Level,  
301-4212
- 6 **Patrick's Irish Pub**,  
800 9th St., Ste. B, 301-4412
- 7 **Isla Bonita Mexican Restaurant**  
908 1/2 8th Ave., 346-9170
- 8 **Roasty's**, 920 9th Ave., 356-2806
- 9 **Carl's Jr.**, 720 10th St., 352-9522
- 10 **The Knuckle Sandwich**,  
821 10th St., 352-8008
- 11 **Woody's Newsstand**,  
942 9th Ave., 352-8117

## More Greeley Downtown Restaurants

Canton Garden - 1330 8th Ave., 353-7314  
 Cheba Hut - 1645 8th Ave., 673-8733  
 Chipotle's Mexican Grill - 807 17th St., #A, 346-8700  
 The Country Inn - 1415 8th Ave., 353-8530  
 D.P. Dough - 901 16th St., 336-8888  
 Hope Mexican Restaurant - 1029 9th St., 378-4894  
 Randy's Chicken Coop - 1635 8th Ave., 673-8796  
 Santeramo's Pizza House - 1229 10th Ave., 353-4844  
 Taste of Philly - 829 16th St., 336-0010  
 The Kitchen - 905 16th St., 351-7396

The Ranch Restaurant - 714 6th St., 356-1411  
 Tropical Sno - 923 16th St., 352-7036  
 Winchell Donut House - 1503 8th Ave., 353-5728

### Coffee Shops

Margie's Java Joint - 931 16th St., 356-1687  
 Zoë's Café, 715 10th St., 352-2089  
 Winchell Donut House - 1503 8th Ave., 353-5728  
 Woody's Newsstand - 942 9th Avenue, 352-8117

Restaurant Guide Provided by:



Union Colony Civic Center

Greeley, Colorado

Hensel Phelps Theatre

updated August 2010

Travel Directions:

From North or South on I-25 take US 34 East exit. Go east approx 10 miles to the US 34 Business Exit. Take that Exit and continue east into town. (Business 34 becomes 10<sup>th</sup> Street). Proceed through town to 11<sup>th</sup> Ave and turn left (North). Go three blocks to 7<sup>th</sup> Street. The loading dock is at 11<sup>th</sup> Ave and 7<sup>th</sup> Street.

From Highway 85 north or south, take 5<sup>th</sup> Street west. Go west about 1 mile to 11<sup>th</sup> Ave and turn left(South). Go two blocks to 7<sup>th</sup> Street. The loading dock is at 11<sup>th</sup> Ave and 7<sup>th</sup> Street.

Union Colony Civic Center  
Greeley, Colorado  
Hensel Phelps Theatre  
updated August 2010

Loading Dock:

The loading dock is approximately 45' from the freight elevator. The height of the loading dock is 48". There is room for two trucks at the dock. The primary loading space is equipped with a dock leveler and has a loading door 8'-0" x 10'-0". The secondary space has no leveler and has a door 6'-0" w x 7'-0" h.

Shore Power:

100 amps 3 phase (lugs) located just inside the dock door

**NOTE: TRUCKS AND BUSES ARE NOT ALLOWED TO BE KEPT RUNNING IN THE LOADING DOCK AREA!**

Freight Elevator:

The elevator is 8'-0" w x 8'-9" deep x 8'-0" h. A 12' flat will fit (barely) on the diagonal.

Work Room:

The freight elevator opens into a work room that is located offstage right from the stage. The workroom is "L" shaped and is approximately 1000 square feet. The access door from the workroom to the stage is 7'-8" w x 10'-0" h.

Dressing Rooms: There is one Star Dressing Room. This room has a toilet and sink as well as a counter/mirror for makeup. There are also 2 dressing rooms out on the dock. These do not have any plumbing nor any counter space. There are coat racks that can be rolled into these for costumes.

Union Colony Civic Center  
 Greeley, Colorado  
 Hensel Phelps Theatre  
 updated August 2010

Seating Capacity: 213

Dimensions:

Proscenium Width:	29'-4"	Pros to US Fly pipe:	14'-6 ½ "
Proscenium Height:	14'-6 "	Pros to DS edge of apron (CS)	8'-6"
Wing Space (Pros to wall)		Pros to support column	15'-10"
	SR: 9'-8"	DS edge of apron to US wall	30'-6"
	SL: 8'-11"	Support column to SL wall	11'-2"
Centerline to wall		Support column dimensions	1'-5"
	SR: 24'-4"		square
	SL: 23'-6"	Orchestra Pit:	none

The Stage floor is black painted masonite over T & G fir.

**NAILING, SCREWING OR LAGING INTO THE FLOOR IS PERMITTED WITH PRE-DRILLING.**

There are 6 stage braces (weighted base) available.

Soft Goods:

The Main Curtain is a traveler (operated from DSR) and is "Eggplant" color (bright purple).

The upstage traveler is operated from USL and draws to that side - it does not split in the center.

There is *one* fly pipe in this theatre. A 22'x31' natural muslin cyc is available for use on this pipe. It is located directly US of the US traveler. Maximum fly height is 22'8". The electrics and soft goods are dead hung and there are only 3 semi-free pipes. These pipes have legs on them at the SR side. The rest of these pipes are empty.

Union Colony Civic Center

Greeley, Colorado

Hensel Phelps Theatre

updated August 2010

**HENSEL PHELPS RIGGING SYSTEM**

The system is a dead hung system of battens on trim chain.  
All battens are 35' long, (10.668 m) 1½" (3.81cm) I.D.

	<b><u>Distance from Pros</u></b>		<b><u>Use</u></b>	<b><u>Pipe Trim</u></b>
	<b><u>Feet/Inch</u></b>	<b><u>Meters</u></b>		
0	-2'-6"	.15m	House Valance	21'-6"
1	6"		Grand Drape	21'-5"
2	1'-0"		Border (5' high)	21'-5"
3	2'-0"		1 <sup>st</sup> Electric	18'-9"
4	4'-0"		Legs	21'-5"
*5	4'-8"		Border (5' high)	21'-6"
6	8'-0"		2 <sup>nd</sup> Electric	20'-9"
7	10'-0"		Legs	22'-2"
8	11'-0"		Border (5' high)	21'-6"
9	13'-0"		Legs	21'-5"
10	13'-9"		Traveler	21'-5"
11	14'-6"		Fly Pipe/Cyc	22'-8"

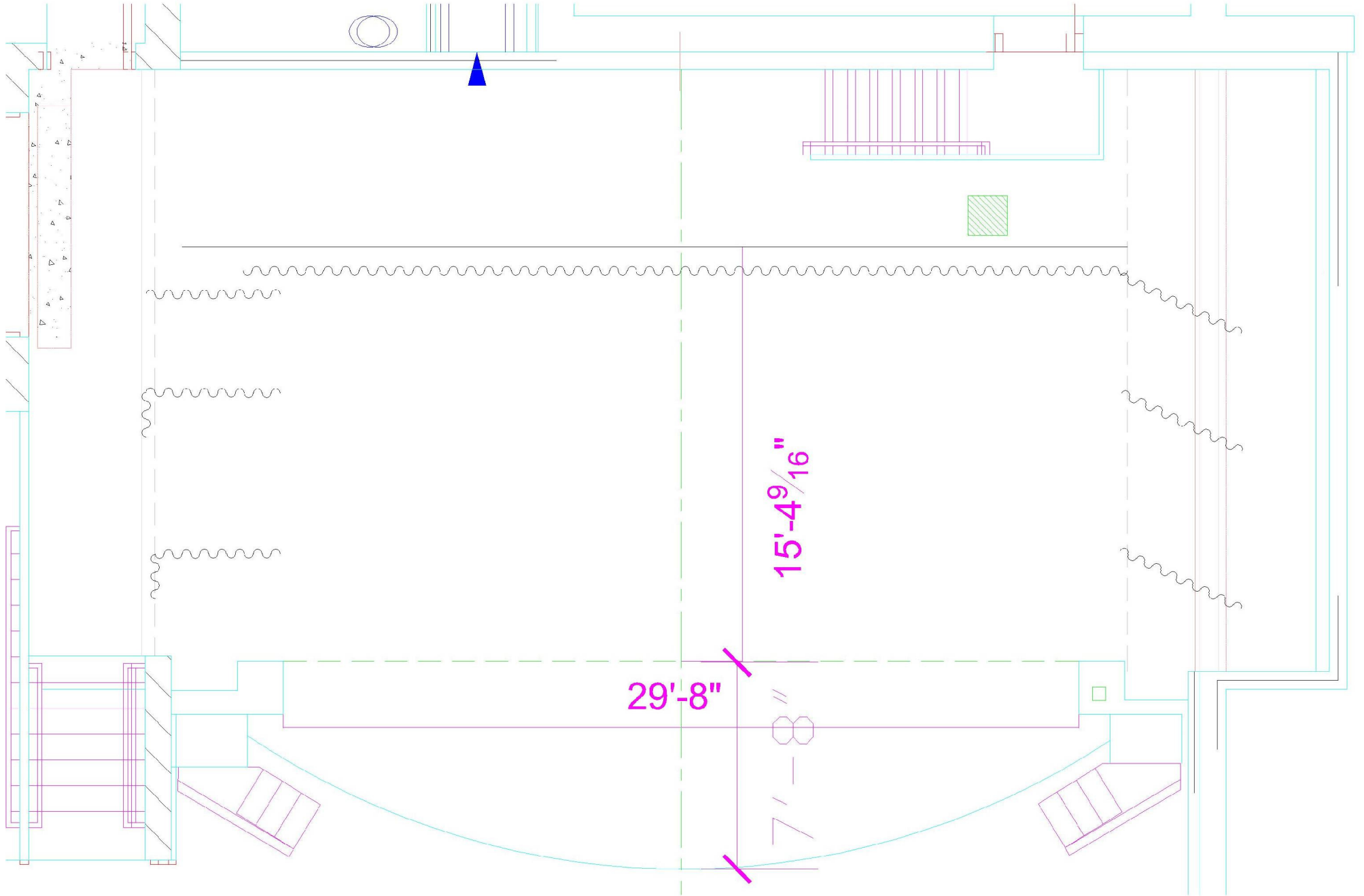



Union Colony Civic Center  
Greeley, Colorado  
Hensel Phelps Theatre  
updated August 2010

Electrics:

Dimmers: 76 (Dimmer per circuit)

Capacity: 2.4k

Light Board: ETC Express24/48

Lighting Positions:

Beams: 25 circuits

1st Electric: 16 circuits

2nd Electric: 15 circuits

5 Floor Pockets: 4 circuits each

*(Paperwork for rep plot is available upon request)*

Instrument Inventory:

Source 4 Jr. Zoom	375w	15
Source 4 19 degree	375w	3
Source 4 36 degree	375w	2
Source 4 Parnel	375w	12
Colorado 2 Tour LED Par	LED	12
Follow Spot	360w Ultra Quartz	1

6 Boom Bases with 8' and 10' Pipe are available for use in this theatre.

**ALL INSTRUMENTS HAVE A GROUNDED STAGE PIN CONNECTOR**

House lights can be controlled from either DSR or the light booth. House lights can NOT be controlled from the light board.

A 21'-6" extension A Frame ladder is available for focus. A 32' personal lift is also available if not in use in Monfort Concert Hall.

Union Colony Civic Center  
Greeley, Colorado  
Hensel Phelps Theatre  
updated August 2010

Audio:

The console is a Soundcraft GB2R 12/2. This console has 12 mono inputs and 2 stereo inputs. It also has 6 aux, 2 subgroups, and a stereo out. There are 12 channels from Stage to the console for audio. There are also 4 monitor sends to the stage for playback and audio reinforcement. The House speakers are a Meyer UPA-1 with a Meyer USW-1 per side. It is now a Stereo house system. A Tascam CD-A500 CD player / cassette deck is available for playback as well as a TEAC CD-P1260 CD player. There is a T.C. Electronic M1 unit as well as 4 channels of Drawmer compression that can be patched into any channel. There are two 15" monitors as well as four 12" monitors that may be used in the space.

There are only 2 wireless systems installed in Hensel Phelps. They can be 2 Hand-Helds or 2 Lapels or a combination. Other microphones may be used from the UCCC inventory as long as they are not being used in Monfort Concert Hall.

Sound Levels:

Sound levels in excess of 94dB sustained and 100dB peak are not permitted. There is equipment installed that will limit sound pressure limits. Once the sound level peaks at 100dB, sound levels will be reduced by 6dB for a period of 5 seconds.

**Technical Regulations:**

Flame proofing:

All elevated scenery (including platform facings) are to be flame proofed in accordance with the Uniform Building Code and Uniform Fire Code. All scenery must meet the minimum requirements for Class B Interior Finish as set forth in UBC Chapter 42, table 42b. Written proof of the testing of the paint or flame proofing used may be required before the scenery is allowed into the Union Colony Civic Center. The testing may be New York, California, or other nationally recognized standards.

Union Colony Civic Center  
Greeley, Colorado  
Hensel Phelps Theatre  
updated August 2010

Pyrotechnics:

The use of fire, flash pots, pyrotechnics, atmospheric effects, fireworks or firearms require a special permit from the Greeley Fire Department. Fireworks is defined as any combustible substance or device prepared for the purpose of producing a visual or audible effect by combustion, explosion, deflagration, or detonation. NOTE: The approval for this permit may not be available after hours or on weekends or holidays without advance notice.

Smoking:

Colorado State Law mandates that the Union Colony Civic Center will be a no smoking house. Absolutely no smoking is allowed on the stage, in the wings, workshop, dressing rooms, greenroom, control booths, or in the house. Smoking is permitted onstage only as required during the action of a performance or rehearsal.

Food and Drink:

Food and drink are not allowed on the stage or in the wing areas, except as required during the action of a performance or rehearsal. Food and drink are not permitted in the control booths at any time.