

City of Greeley

Public Works

Crossing Approval Packet For All Water & Sewer Crossings



Contact: Mary Kendrick
Administrative Specialist II
1001 9th Ave
Greeley, CO 80631
Ph: (970) 350-9881
Fx: (970) 350-4141
mary.kendrick@greeleygov.com



CROSSING APPROVAL PROCEDURES
CITY OF GREELEY
PUBLIC WORKS
1001 9TH AVE. ■ Greeley, CO 80631
Contact: (970) 350-9881

APPROVAL PROCEDURES: Please note the Crossing Approval issued by Water & Sewer applies **ONLY** to Water & Sewer pipelines. Contractor/Owner is responsible for identifying and obtaining any and all permits and/or approvals required from any public agency or private property owner. Submit for approval a minimum of 2 weeks prior to construction.

- 1) **POT HOLE OF EXISTING WATER & SEWER PIPELINES:** When a new proposed project identifies that a City of Greeley Water & Sewer Pipeline is within the project area, the water, sewer, non-potable and service pipelines must be pot-holed to determine location and depth of existing pipelines. It is the responsibility of the Contractor/Facility Owner to obtain appropriate approval for doing the pot-hole of the water and sewer pipelines. This is done by submitting a location map showing where the Contractor/Facility Owner will be crossing the City of Greeley water and/or sewer pipelines. When in public right of way, the appropriate permit must be obtained from the agency with jurisdiction for the road. Water & Sewer Department will **sign off or issue an “OK to Pothole”** as requested by the Public Works Department. When on private property within a City Easement area, the approval or right of entry must be obtained from the property owner. The Water and Sewer Department **DOES NOT** issue pot-hole permits or private property approvals.
- 2) **CROSSING APPROVAL APPLICATION:** Complete all pertinent information.
- 3) **PLAN AND PROFILE DRAWING REQUIRED (After Potholing Completed):**
(Attached is Minimal Design Standards and sample Plan & Profile Drawing):
 - A. Plans to show location information and placement of facility being installed, incorporating location and depth of pipelines identified by pot-hole.
 - B. Plans to show how facility will be installed (bore, trench, other).
 - C. Plans to show type, size, etc. of facilities being installed, including crossing tape, marker posts, etc.
 - D. City of Greeley water, sewer and non-potable and service pipelines to be identified, if located in City of Greeley Water & Sewer easement the easement width shall be shown on drawing.
 - E. The **actual** proposed distance of clearance, both vertical and horizontal, to be shown from new facility to existing water and sewer pipelines.
- 4) **SUBMIT COMPLETED APPLICATION AND PLAN/PROFILE DRAWING:** Submit to Water & Sewer a **minimum of two weeks** prior to proposed construction date.
- 5) **PLAN CHECK REVIEW BY WATER & SEWER:** Plan check and review of application to be completed by Water & Sewer, which requires confirmation of easement width, approval of proposed clearance and installation. Additional information and/or drawing revisions will be requested if necessary.
- 6) **CROSSING APPROVAL ISSUED:** When all information is received and plan & profile drawing approved, City of Greeley Water and Sewer will (1) issue **Original/Signed** Crossing Approval Application; (2) provide any Approval Conditions that apply and (3) **Stamp, Sign & Date** approved Plan/Profile Drawing. The Original of the Approval and the Plan & Profile Drawing will be furnished to Contractor/Owner (**these must be on-site during construction**), with a copy available for Water & Sewer Inspector. **Contractor/Owner is responsible for identifying and obtaining any and all permits and/or approvals required from any public agency or private property owner.**
- 7) **INSPECTION NOTICE:** Contractor/Owner to arrange for City of Greeley Water & Sewer inspector prior to any construction activities, including potholing, within the City of Greeley Water & Sewer Easements and/or existing water, sewer, or non-potable pipelines in a public street Right of Way.

**CITY OF GREELEY
WATER AND SEWER DEPARTMENT**

**MINIMAL STANDARDS FOR UTILITIES CROSSING OR PARALLELING
EXISTING WATER AND SEWER PIPELINES**

The following requirements are standard and pertain to every utility that intends to cross or parallel our existing potable/non-potable water, sewer and service lines. These minimum standards were developed to meet the State of Colorado Design Criteria for Potable Water Systems per Colorado Department of Public Health & Environment. **These are minimal standards that may be changed upon plan review due to field conditions, soil conditions, service line connections, maintenance/repair of pipelines, and adjacent manholes.** Installation plans must be submitted to the Water & Sewer Department, 1100 10th St., Greeley Colorado 80631 for review and approval a minimum of **two weeks prior** to the beginning of construction.

MINIMAL REQUIREMENTS:

Parallel Installation

Parallel installations shall maintain a minimum of 5 feet clear horizontal separation in a public right-of-way for dry utilities. All oil or natural gas pipelines shall maintain a minimum of 10 feet clear horizontal separation. Parallel installations **shall not** be allowed in exclusive water and sewer easements.

Perpendicular Crossings Installation

For bored crossings, there shall be a minimum of 2 feet clear separation above or a minimum of 3 feet clear separation below existing water or sewer mains or services. When reaming, you must allow for the outside diameter of the reamer plus the applicable 2 or 3 feet distance.

For open cut crossings, a minimum of 18" clear separation above or 3 feet clear separation below existing water or sewer mains or services.

(NOTE: The **exact** clearance distance, **not the minimum**, must be shown on the profile.)

All crossings shall be contained in an encasement pipe that can be:

| | |
|--|-----------------------------------|
| DIP CI 51 | Schedule 80, PVC |
| Steel with a minimum of .25 wall (Schedule 40) | Arncor Corporation's "Smooth-Cor" |
| SDR 11HDPE polyethylene piping | BoreGard |

(NOTE: Any variation from above conduits must be reviewed and approved by Water & Sewer)

The encasement piping shall span a minimum of 10 feet on both sides and be centered on the existing water or sewer main.

Any crossing that spans an exclusive water or sewer easement shall span the entire easement with the casing.

All crossings must be at a 90-degree angle to the water or sewer main.

Research Required

Potholing (check with Public Works for specifications and permit) is required to verify the depth of the water or sewer line and must be witnessed by a representative of the Water & Sewer Department. This acquired data must be shown on a profile view on the proposed crossing plan. To allow for approval review, the plan, along with a completed crossing approval application, must be **submitted a minimum of two weeks** in advance of construction.

A Water & Sewer representative shall verify all crossings. To schedule this service, call 350-9320 **forty eight hours** prior to needing the representative.

Sample Crossing Approval Plan and Profile in Public ROW

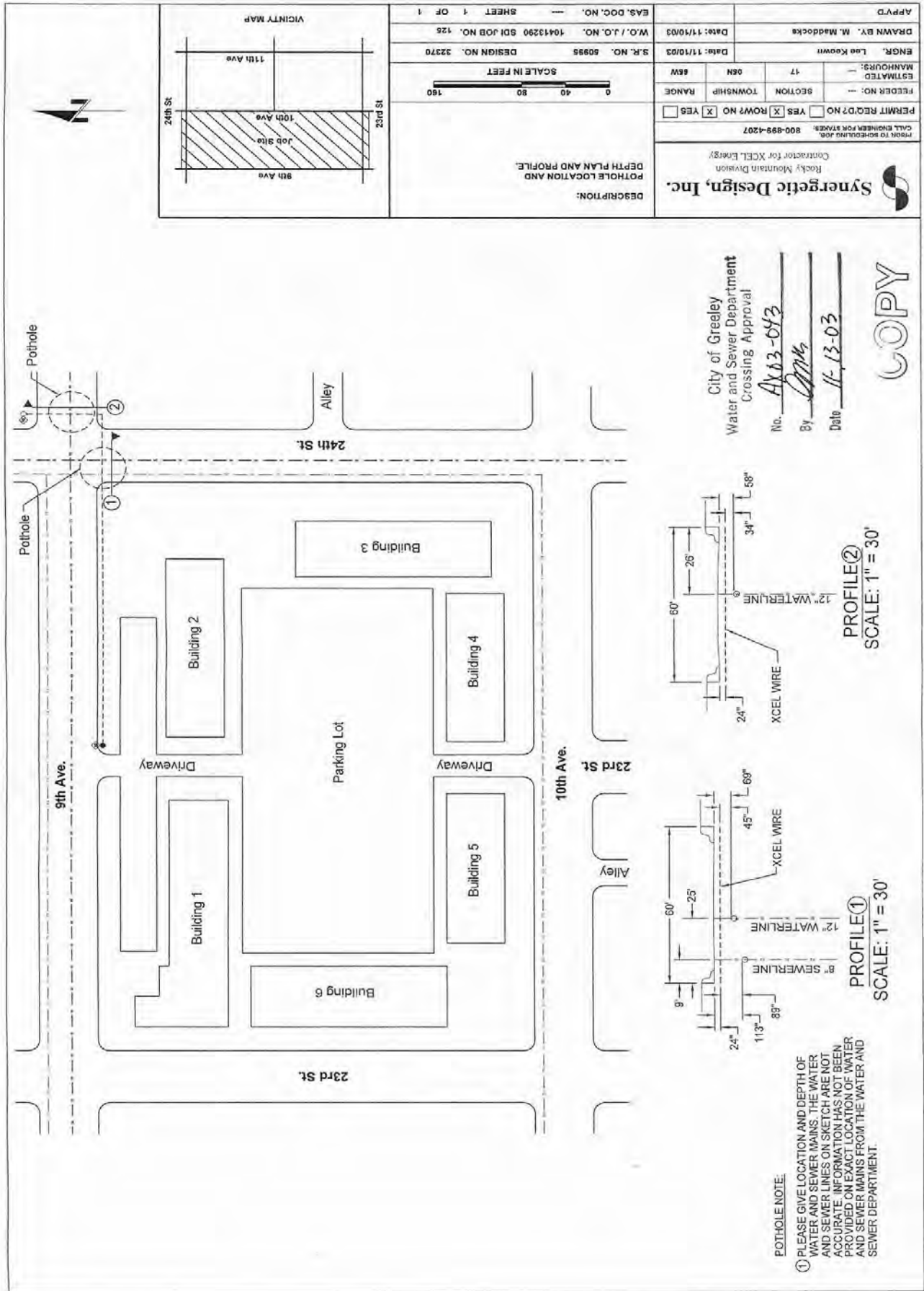

| | | | |
|---|-------------|----------------------------|---|
| APRVD | | DRAWN BY: M. Maddocks | |
| ENGR: Leo Kooviv | | Date: 11/10/03 | |
| ESTIMATED MANHOURS: 17 | SECTION: 17 | DESIGN NO.: 32370 | W.O./J.O. NO.: 10413290 SDI JOB NO. 125 |
| FEEDER NO.: | | S.R. NO.: 80996 | |
| PERMIT REQ'D? NO <input type="checkbox"/> YES <input checked="" type="checkbox"/> | | SCALE IN FEET | |
| TOWNSHIP RANGE: 17 | | 0 40 80 160 | |
| PERMIT REQ'D? NO <input type="checkbox"/> YES <input checked="" type="checkbox"/> | | VICINITY MAP | |
| CALL ENGINEER FOR PRICES: 800-899-4207 | | 9th Ave, 10th Ave, 24th St | |
| FROM TO SCHEDULE JOB Contractor for XCEL Energy Rocky Mountain Division Synergetic Design, Inc. | | | |
| DESCRIPTION: POTHOLE LOCATION AND PROFILE | | | |

City of Greeley
 Water and Sewer Department
 Crossing Approval
 No. Ax 03-043
 By [Signature]
 Date 11-13-03

COPY

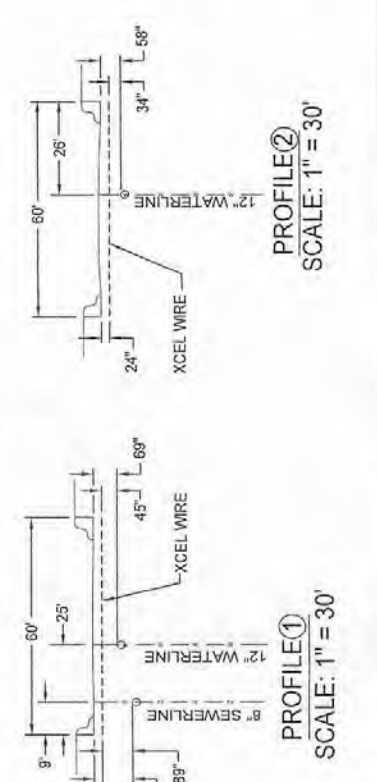

POTHOLE NOTE:
 ① PLEASE GIVE LOCATION AND DEPTH OF WATER AND SEWER MAINS. THE WATER AND SEWER LINES ON SKETCH ARE NOT ACCURATE. INFORMATION HAS NOT BEEN PROVIDED ON EXACT LOCATION OF WATER AND SEWER MAINS FROM THE WATER AND SEWER DEPARTMENT.

Sample Crossing Approval Plan and Profile in Private Easement

POUDRE VALLEY RURAL ELECTRIC ASSOC.
FT. COLLINS, COLORADO

FIELD CONTACT: TIM VAUGHN- 303-591-1979

EXHIBIT "A"

T.5N., R.67W., Sec.11
PLAN VIEW NOT TO SCALE

NORTH WATERLINE DIAMETER = 30"
SOUTH WATERLINE DIAMETER = 27"

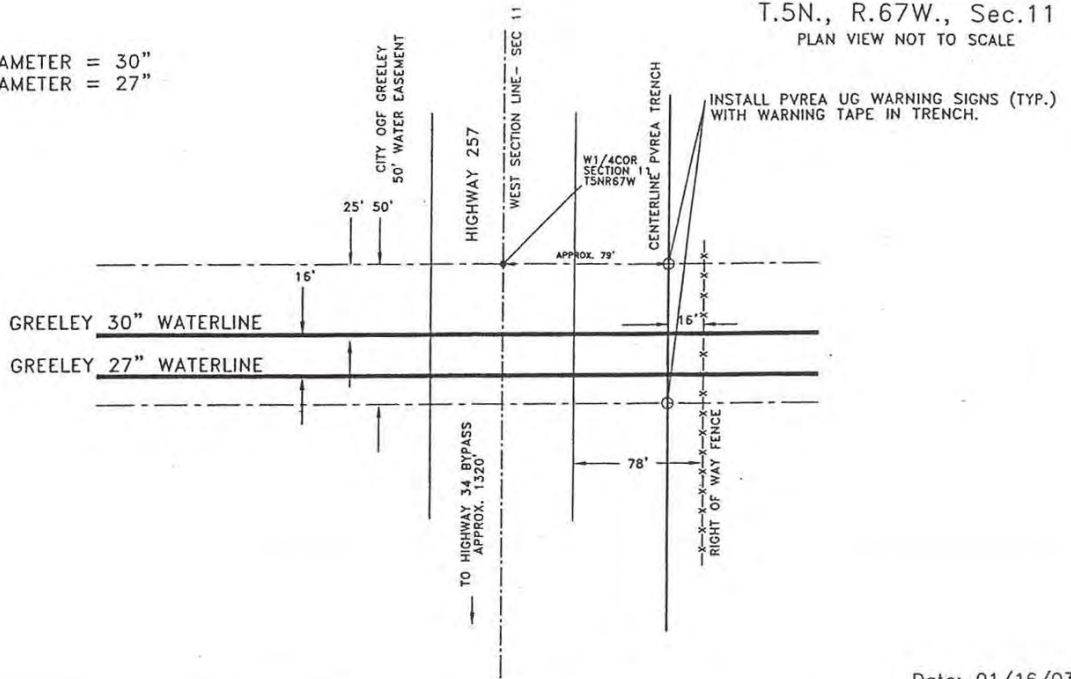

Date: 01/16/03

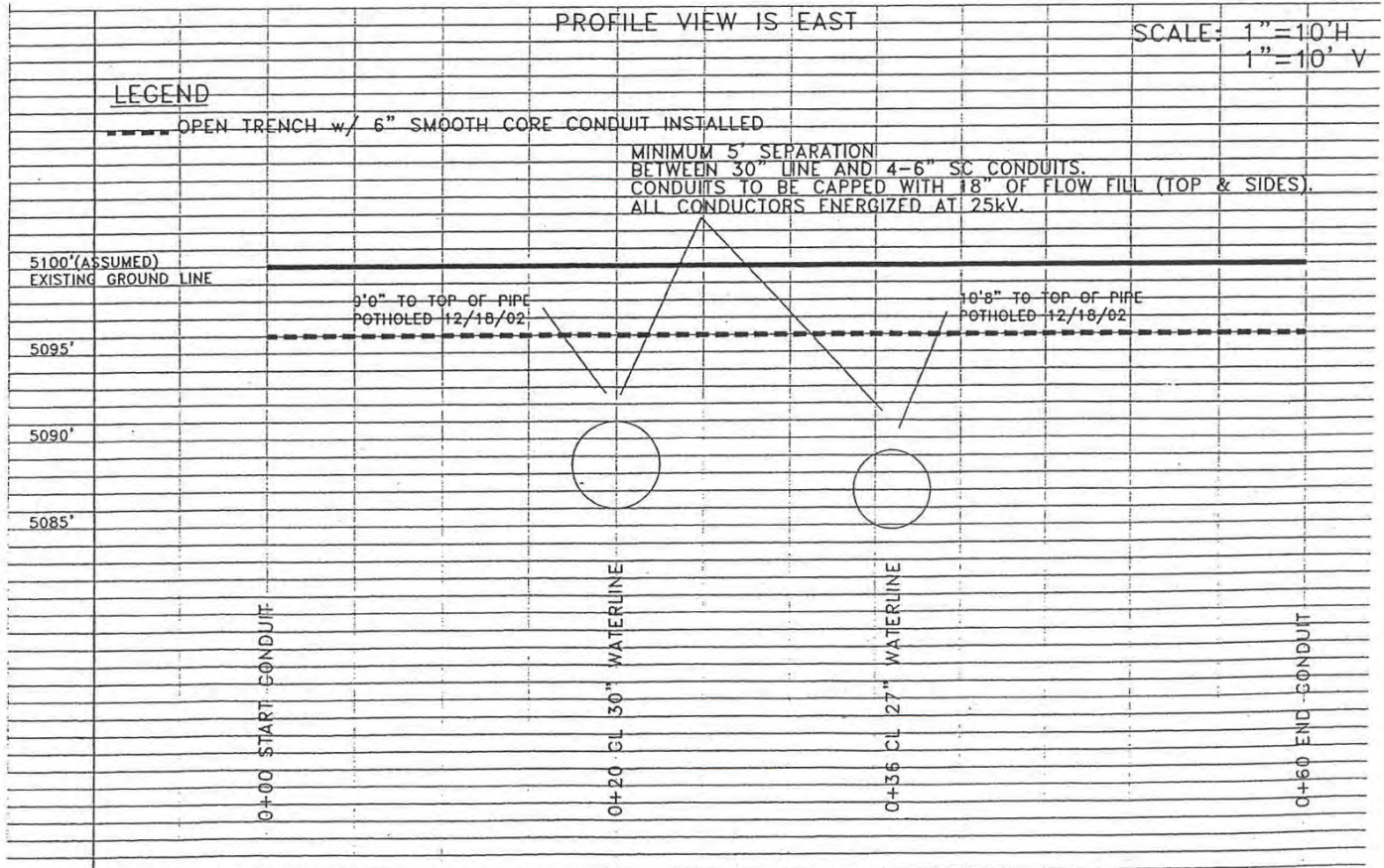



Submitted: _____

| | | |
|------------------------------------|---------------------|--------------|
| <i>W&S Crossing Approval #</i> | <i>Approved By:</i> | <i>Date:</i> |
|------------------------------------|---------------------|--------------|

CROSSING APPROVAL APPLICATION

CONTRACTOR _____
ADDRESS _____

CONTACT _____ **PHONE #:** _____

OWNER OF INSTALLATION _____
ADDRESS _____

CONTACT _____ **PHONE #:** _____

Estimated Construction Date: _____ **Location:** Section _____, T _____ N, R _____ W
 Address or Intersection _____

Description: *Distance/direction (_____ft N S E W) from cross street, side of street, etc.*

Method of Installation: Bore Open Trench Other _____

Encasement conduit material, size & type: _____

Description of Facility to be installed (pipe size, KV info, Telephone/Cable/etc.): _____

| City of Greeley Facility | | | Crossing Information | | Private Easement Information | |
|--|-----------|---------------|----------------------|--------------------|------------------------------|------------------|
| Water, Sewer, Non-potable, service line and/or Trans. Line # | Pipe Size | Pothole Depth | Over or Under | Crossing Clearance | Width | Reference number |
| a. | | | | | | |
| b. | | | | | | |
| c. | | | | | | |
| d. | | | | | | |

***Note: All Service lines must be potholed and documented.**

On-site Inspector: *(please call at least 48 hours in advance of any construction activities)*

Distribution System -970/350-9320 Transmission System -970/371-3718 (Keith Ikenouye)

Encasement Information:

- Private easement – span entire width of pipeline easement
- Public easement – span a minimum of 10 feet either side of existing lines
- Pipeline marker posts to be placed above conduit on each side of City of Greeley’s Pipeline Easement. Exact location to be determined by field inspector.



**APPROVED APPLICATION MUST BE ON-SITE DURING
 CONSTRUCTION ALONG WITH APPROVED PLAN/PROFILE**