

Addendum #1



Capital Project Committee

Project Information

Project Name:	Island Grove Arena Painting
Bid Number:	RFP #FD20-03-054
Date:	March 24, 2020
Project Manager:	Brian Ward

Addendum Items

Item 1	<p>On page 4 of the RFP it says “This phase of the improvement project shall finalize the remaining planning effort, considering the previous executed improvements, and create an engineering document set for the ultimate construction of the entire area. Does this include the following features:</p> <p>a. Improvements to Butch Butler Field and areas surrounding the field (warning track at outfield fence, bull pens, batting cages, changes to fence lines, etc)? These would be future phasing improvements</p> <p>b. Improvements to Centennial Pool? Does this scope require an aquatics consultant? No, future phasing improvements</p> <p>c. New buildings/structures, or building renovations, that need to be designed by an architect? No new buildings, just some picnic shelters</p>
Item 2	<p>Is the realigned entry drive (#36 in attached master plan graphic) that connects to reservoir road and the parking lots included in the scope? Yes – this portion is included within the scope of this project.</p>
Item 3	<p>The RFP says the Library Parking Lot was expanded. Can you clarify the extent of the remaining parking lot improvements that are included in this scope? The parking lot expansion will be completed by others. No additional planning for the parking lot will be included within this scope however the existing expansion shall be considered in the consultants scope.</p>
Item 4	<p>Does the scope include new lighting in parking lots and/or in other areas? Yes</p>
Item 5	<p>Should we assume that the existing raw water line that runs along the west edge of the reservoir property has enough pressure for the new park irrigation system, or should the scope include design services for an irrigation booster pump? The scope shall include delivery of the raw water system by either means of a booster pump or onsite retention pond / pump system.</p>
Item 6	<p>Does the scope include expansion of, or improvements to, the existing xeriscape garden? The xeriscape garden will not be expanded as part of this project therefore this scope may be excluded.</p>

Item 7	Are the adult fitness stations included in this scope? Yes .
Item 8	Are portions of the existing bluegrass being converted to native grasses as part of this scope? Yes
Item 9	Is an SUE survey required for a portion of the park, or the entire park? No – a SUE investigation will not be required as part of the design consultants scope however survey potholing will be required.
Item 10	Will the City provide the Title Commitment for the Boundary survey, or should the consultant team include the Title Commitment in the scope? The City currently processes and shall provide the title commitments for the boundary survey.
Item 11	Is it correct to assume that the City’s Development Review process (Site Plan Review?) is required for this project? Yes .
Item 12	Do you anticipate the need for an amended plat, recording of easement documents, and/or ROW dedications as part of this scope? No
Item 13	The RFP mentions a Traffic Pattern Analysis. Is a full traffic study required as part of the scope, or something less? Only traffic flow patterns shall be analyzed as part of the design work. No formal traffic study shall be performed as part of this scope.
Item 14	Does the scope include public outreach No , board presentations Possibly exhibits to support the planning review of the project but the consultant will not be required to attend these meetings , public hearings No , a project website No , or similar?
Item 15	Page 12 of the RFP under “Construction Inspection” discusses “daily” construction observation. It also says a construction trailer should be included in the scope. The construction trailer will be provided as part of the construction companies scope of services and shall not be provided by the design consultant. Does this accurately reflect the level of involvement you’d like from the consultants during construction? As part of the proposal the consultant shall supply pricing for supplying construction inspection services for the full project. The City may elect to self-perform these services.
Item 16	See attached Phasing plan - basically from the plan #2 minus the skatepark, #,3,#4 and #5 now and depending maybe #6 and #7

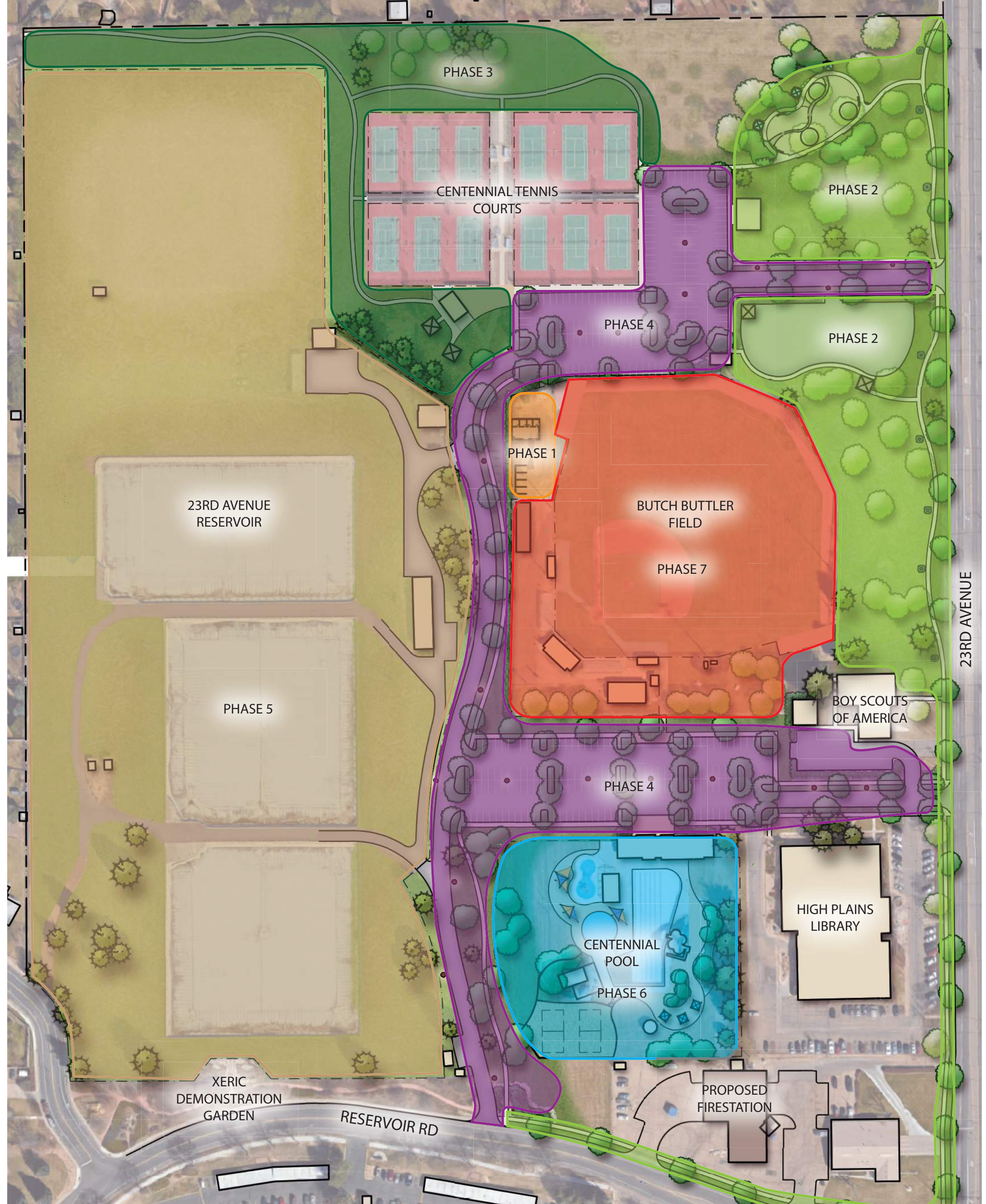

- | | | | | | | |
|----------------------------------------------------------------------------------------------------------------------------------------------|----------------------------------------------------------------------------------------------------------------------------------------------------------------------------------------------------------|-------------------------------------------------------------------------------------------------------------------------------------------------------------|----------------------------------------------------------------------------------------------------------------------------------------------------------------------------------------------------------------------------------------------------------|-----------------------------------------------------------------------------------------------------------|----------------------------------------------------------------------------------------------------------------------------------------------------------------------------------------------------------------------------------------|------------------------------------------------------------------------------------------------------------------------------------------------------------------------------|
| <p>PHASE 1</p> <ul style="list-style-type: none"> -MAINTENANCE BUILDING -MATERIALS BINS -FENCED YARD | <p>PHASE 2</p> <ul style="list-style-type: none"> -SKATEPARK -PLAYGROUND -PICNIC SHELTERS -NATIVE SEED -REALIGN SIDEWALKS -TREE LAWNS | <p>PHASE 3</p> <ul style="list-style-type: none"> -CONNECTING WALKS -NATIVE SEED -LANDSCAPE BUFFERS -PLAZA | <p>PHASE 4</p> <ul style="list-style-type: none"> -STREETSCAPE IMPROVEMENTS -PARKING LOT IMPROVEMENTS -REALIGN DRIVEWAY -LIGHTING -TREES & LANDSCAPE -NEW FENCE AT RESERVOIR SITE | <p>PHASE 5</p> <ul style="list-style-type: none"> -CONVERT BLUEGRASS TO NATIVE SEED | <p>PHASE 6</p> <ul style="list-style-type: none"> -CENTENNIAL POOL UPGRADES -NEW FENCE -SAND VALLEYBALL -PICNIC CABANAS -NEW AQUATIC FEATURE -TREES & LANDSCAPE | <p>PHASE 7</p> <ul style="list-style-type: none"> -TAPERED FOUL LINE FENCE -TALLER OUTFIELD FENCE -BATTING CAGES -BULL PENS |
|----------------------------------------------------------------------------------------------------------------------------------------------|----------------------------------------------------------------------------------------------------------------------------------------------------------------------------------------------------------|-------------------------------------------------------------------------------------------------------------------------------------------------------------|----------------------------------------------------------------------------------------------------------------------------------------------------------------------------------------------------------------------------------------------------------|-----------------------------------------------------------------------------------------------------------|----------------------------------------------------------------------------------------------------------------------------------------------------------------------------------------------------------------------------------------|------------------------------------------------------------------------------------------------------------------------------------------------------------------------------|

GREELEY CENTENNIAL PARK

MASTERPLAN PHASING

11.17.2017

City of Greeley

bha

North ↑

Scale: 1" = 120'