

# COLORADO CULTURAL RESOURCES INVENTORY

OAHP Site #: **5.WL.7873**

## Greeley 8th Avenue Survey

### Historical and Architectural Reconnaissance Form

Eligibility Evaluation (OAHP use only)

Date \_\_\_\_\_ Initials \_\_\_\_\_

\_\_\_\_ Determined Eligible – NR

\_\_\_\_ Determined Eligible - SR

\_\_\_\_ Needs Data

\_\_\_\_ Eligible District – Contributing

\_\_\_\_ Eligible District - Noncontributing

### IDENTIFICATION

- Current Property Name: **Bonacasa Building**  
Historic Property Name: **Greeley Chevron Station**
- Resource Classification: **Building**
- Ownership: **Private**  
Owner(s) contact info:

### LOCATION

- Street Address: **1506 8th Avenue**
- Municipality: **Greeley, Colorado**
- County: **Weld**
- USGS Quad (7.5'): **Greeley, Colorado** year: **1950** **Photorevised 1980**
- Parcel Number: **096108225019**
- Parcel Information: Lot(s): **45** Block: **165** Addition: **Elmwood**
- Acreage: **< 1 (5472 square feet)**
- PLSS information: Principal Meridian: **6th** Township: **5 North** Range: **65 West**  
**NE<sup>1</sup>/<sub>4</sub> SW<sup>1</sup>/<sub>4</sub> SE<sup>1</sup>/<sub>4</sub> NW <sup>1</sup>/<sub>4</sub>** of section **8**
- Location Coordinates: **Zone 13** **526254 mE** **4473877 mN**  
Datum: **NAD83**

### DESCRIPTION

- Construction features (forms, materials)  
Property Type: **One Story Commercial Building**  
Building Plan: **Irregular Plan**  
Dimensions in Feet: **68' N-S by 45' E-W overall dimensions**  
Stories: **One**  
Architectural Style/Type: **Modern Movements**  
Foundation: **Concrete**  
Walls: **Painted pale grey stucco, with painted dark grey 1" by 4" trim boards.**

Windows: **The west-facing (façade) wall contains two single-light fixed-pane windows, and a set of paired single-light fixed-pane windows. Another set of paired single-light fixed-pane windows, near the south end of the façade, are within a former service bay garage door opening which has been filled in and stuccoed.**

Roof: **Flat Roof**

Chimney(s): **N/A**

Porch(s) / Doors: **A grey metal door enters the building near the center of the façade.**

14. Landscape (important features of the immediate environment)

- Garden       Mature Plantings       Designed Landscape       Walls       Parking Lot
- Driveway       Sidewalk       Fence       Seating

### HISTORICAL ASSOCIATIONS

15. Historic function/use: **Commerce/Trade / Gas Station**  
 Current function/use: **Vacant / Not in Use**
16. Date of Construction: **Circa 1963 (per city directories, Sanborn maps, and Assessor records)**
17. Other Significant Dates: **N/A**

18. Associated NR Areas of Significance

- |   |  |  |  |  |
|---|--|--|--|--|
| <input type="checkbox"/> Agriculture                      | <input checked="" type="checkbox"/> Architecture | <input type="checkbox"/> Archaeology               | <input type="checkbox"/> Art             | <input checked="" type="checkbox"/> Commerce |
| <input type="checkbox"/> Community Planning & Development | <input type="checkbox"/> Conservation            | <input type="checkbox"/> Economics                 | <input type="checkbox"/> Education       | <input type="checkbox"/> Engineering         |
| <input type="checkbox"/> Entertainment/Rec.               | <input type="checkbox"/> Ethnic Heritage         | <input type="checkbox"/> Exploration/Settlement    | <input type="checkbox"/> Health/Medicine | <input type="checkbox"/> Industry            |
| <input type="checkbox"/> Invention                        | <input type="checkbox"/> Landscape Architecture  | <input type="checkbox"/> Law                       | <input type="checkbox"/> Literature      | <input type="checkbox"/> Maritime History    |
| <input type="checkbox"/> Military                         | <input type="checkbox"/> Performing Arts         | <input type="checkbox"/> Philosophy                | <input type="checkbox"/> Politics/Gov't. | <input type="checkbox"/> Religion            |
| <input type="checkbox"/> Science                          | <input type="checkbox"/> Social History          | <input checked="" type="checkbox"/> Transportation | <input type="checkbox"/> Other           |  |

19. Associated Historic Context(s) (if known): **City of Greeley 8th Avenue Survey; Greeley Downtown Historic District**

20. Retains Integrity of:  Location     Setting     Materials     Design     Workmanship     Association     Feeling

21. Notes:

**This property is located on the east side of the 1500 block of 8<sup>th</sup> Avenue. A small parking lot is located in front of the building. Another one-story commercial building, addressed as 1500 8<sup>th</sup> Avenue, is adjacent to the north. A former residence at 1510 8<sup>th</sup> Avenue is to the south. The building's exterior has been significantly altered in recent decades so that it has lost much of its historic physical integrity.**

22. Sources:

**The Greeley City and Rural Route Directory. (Generally published annually by *the Greeley Tribune-Republican Publishing Company.*)**

**Sanborn Insurance Company maps for Greeley, Colorado dated June 1886, December 1887, January 1891, October 1895, January 1901, January 1906, October 1909, January 1918, April 1927, September 1946 (as an update of the April 1927 Sanborn maps), August 1968 (also as an update of the April 1927 Sanborn maps).**

**Weld County Assessor Property Information Map. <http://www.co.weld.co.us/maps/propertyinformation>**

**Weld County Assessor Property reports. <https://propertyreport.co.weld.co.us>**

## FIELD ELIGIBILITY RECOMMENDATIONS

Local Landmark Eligible?  yes  no  needs data

Individually State Register Eligible?  yes  no  needs data

Individually National Register Eligible?  yes  no  needs data

Contributes to a Potential Historic District?  yes  no  needs data  property is not located within a potential district

## RECORDING INFORMATION

Recorded by: **Carl McWilliams**

Date: **November 30, 2015**

Affiliation/Organization: **Cultural Resource Historians LLC**

Phone Number: **(970) 493-5270**

Report title: **Greeley 8<sup>th</sup> Avenue Comprehensive Historic Resource Survey**

Project Sponsor: **City of Greeley Historic Preservation Office**

Photo Log: **CD 2, Images 36-38**

### SKETCH PLAN

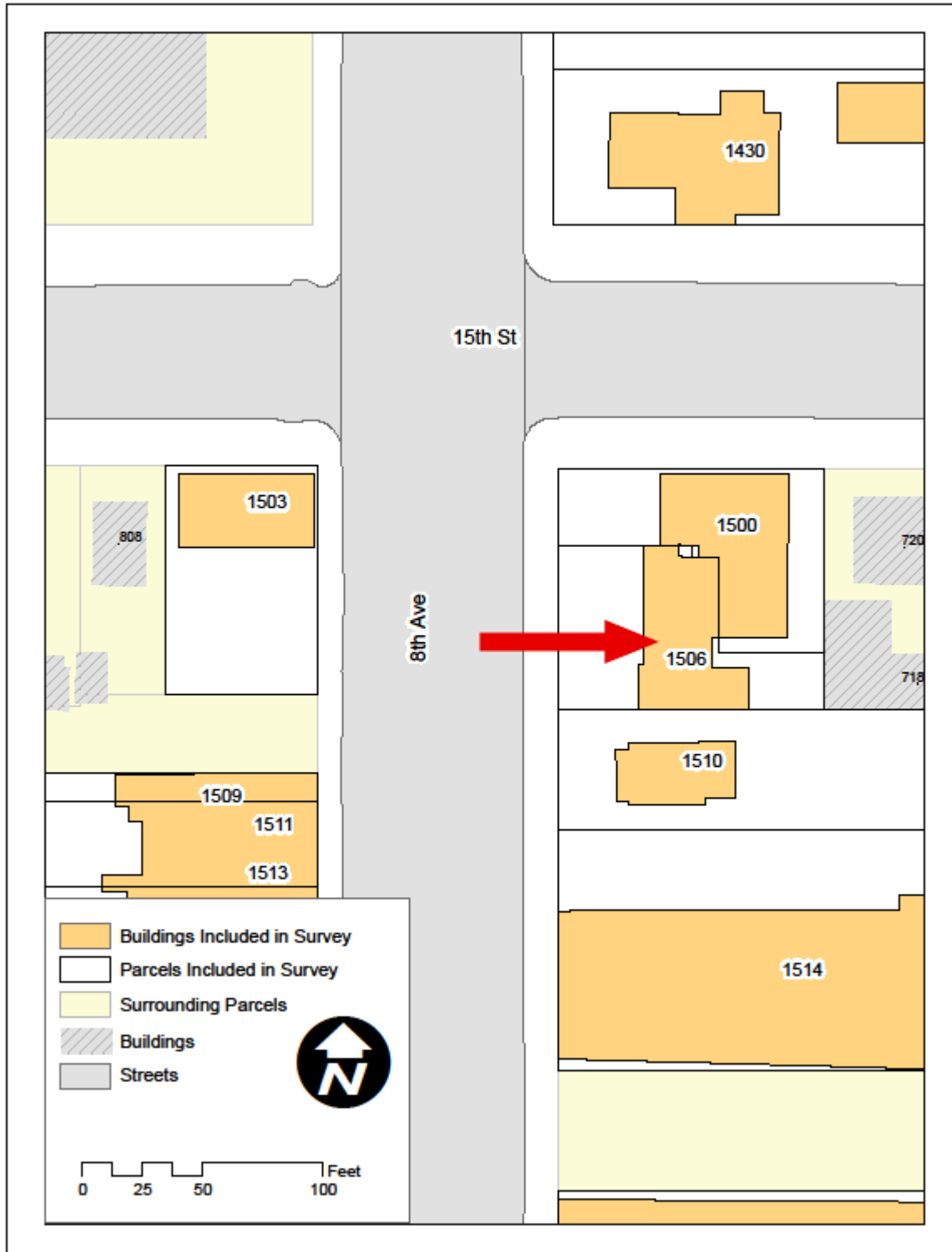

# LOCATION MAP

## 1506 8th Avenue

AllTrails NATIONAL GEOGRAPHIC

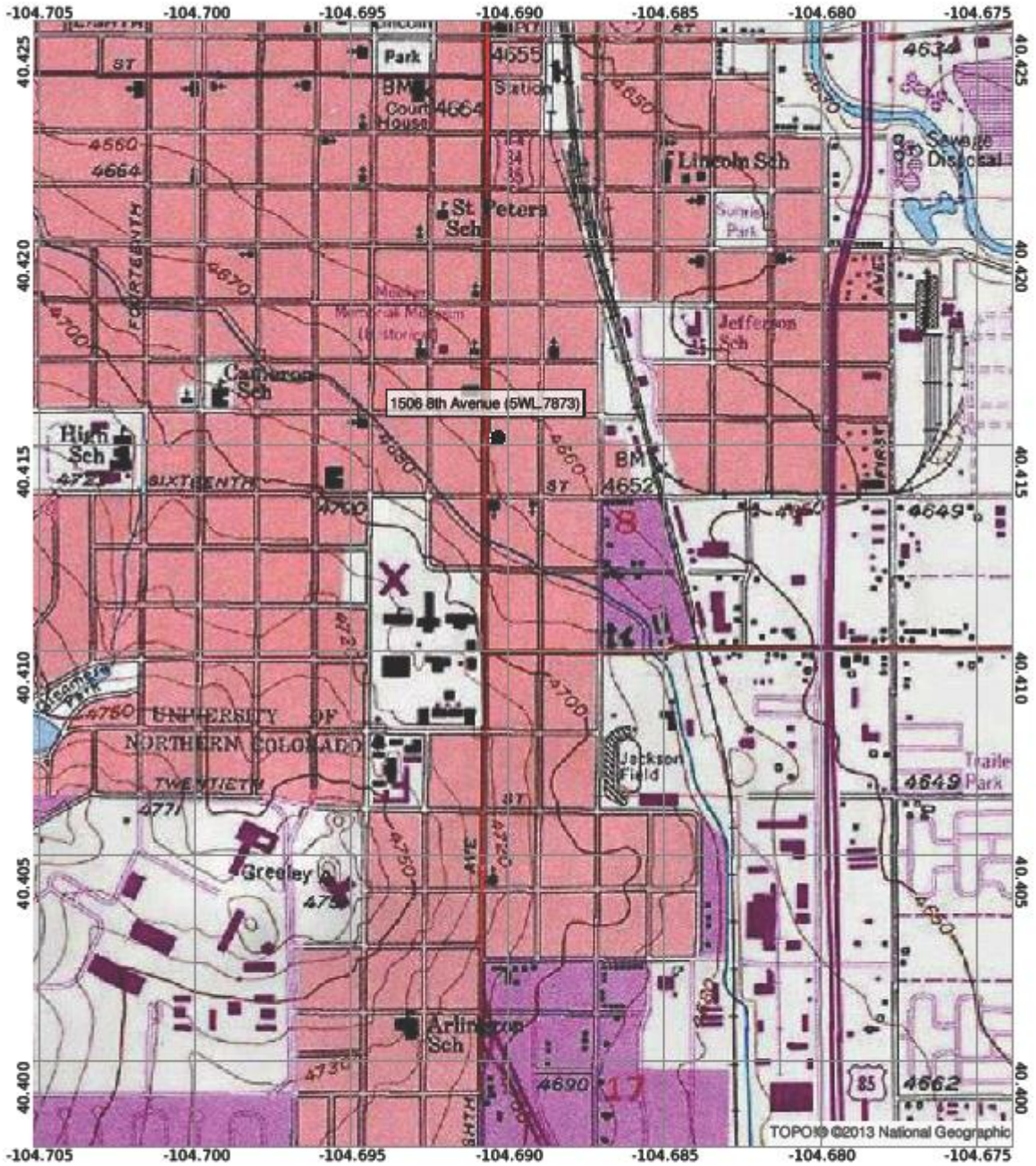

8.2°E  
2/22/15

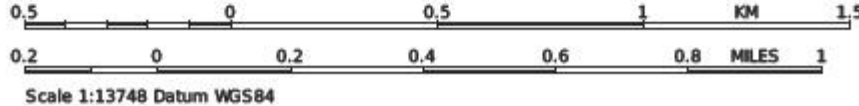





CD 2, Image 36, View to SE of façade (west)



CD 2, Image 37, View to ENE of façade (west)



*CD 1, Image 38, View to NE of façade (west) and south side*